



PWG-TY 20L

PWG-CT 10L

INSTRUCTIONS MANUAL



PlanetsWater (Worldwide) Corp. Proprietor: Daniel C. Matthews
Specialized Atmospheric Imported Product's (SAIP) Thai-China Corp.
PWG-TY 20L Units Instructions Manual – English Version 1.0.4 © 2010

Contents

I .INTRODUCTION	-----1
II. SAFETY NOTES	-----1
III. PRECAUTIONS	-----1
IV. MAINTENANCE	-----2
V . HOW DOES YOUR ATMOSPHERIC WATER GENERATOR WORK?	-----2
VI. FEATURES OF ATMOSPHERIC WATER GENERATOR	-----4
VII. OPERATING YOUR ATMOSPHERIC WATER GENERATOR	-----5
VIII. TROUBLE SHOOTING	-----15
IX. TECHNICAL SPECIFICATIONS	-----18

I . INTRODUCTION

Thank you for purchasing the Planets Water Atmospheric Water Generator. The Atmospheric Water Generator is a new, state-of-the-art water-generating machine, which uses some of the latest and most sophisticated technology available in the industry today. We have designed your Atmospheric Water Generator with one objective in mind i.e. to produce the maximum amount of high quality drinking water while using only minimum amount of electricity. Also with external connection to city water, the machine will serve as water purifier as well.

II . SAFETY NOTES

1. The socket should be equipped with reliable protection earthing/ grounding.
2. Do not remove earthing/grounding terminal from the power cord.
3. Do not use extension plug nor extension adaptor.
4. Always keep the unit away from poisonous gases and liquids.
5. Do not use damaged electrical plug or power cable.
6. Unplug power cord before maintenance.
7. Do not share the electrical socket with other high power consumption appliance.
8. Always use correct replacement parts.
9. Do not unplug power cord with wet hands.
10. Use the enclosed water pipe kits to connect with city water input. Do not use any old water pipelines to connect to the unit.
11. When moving the machine, please unplug the power cord and empty water in all tanks. Do not tilt the machine more than 20° during moving.

III. PRECAUTIONS

1. Do not place the unit too close to the wall. Best performance is obtained when the unit is placed at least 50 cm from the wall;
2. This unit is not for outdoor use;
3. Avoid prolonged exposure to direct sunlight;
4. Keep the unit working in standing position;
5. Operating voltage must not drop below 10% of standard Power supply. When the unit operates below this level, the unit becomes noisy with the possibility of overheating. When this occurs, immediately switch the unit off until the voltage returns to normal;
6. Avoid prolonged direct eye contact to ultraviolet device, as it may cause damage to the eye;
7. Prevent children playing with hot water knob to avoid injuries.
8. Do not spray or use any cleaning agents to clean the unit.

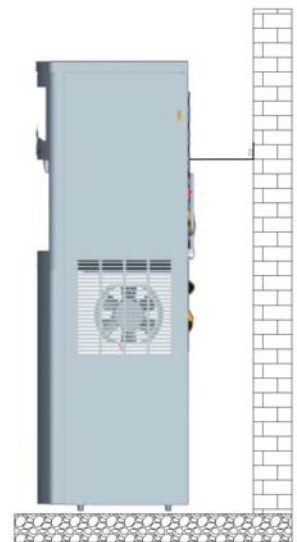

9. To prevent the machine from freezing, please drain off the remaining water and stop operating the machine if the environment temperature is below 0°C.
10. If there is any damage to the power cables, the cables must be repaired or replaced by an authorized person to avoid danger;
11. For the condition of operating on uneven ground, a fixer should be mounted to the unit's bottom part.
12. Do not place any objects on top of the machine. Good ventilation is required to ensure optimum performance.

IV. MAINTENANCE

1. Always keep the unit clean. Wipe the outer casing with soft, damp fabric to clean. Use water to clean, avoid using strong cleaning agents.
2. Do not use cleaning agents to clean storage tanks.
3. Clean air filters regularly to ensure optimum air flow.
4. Always drain out the remaining water from the tanks before a long period of inactivity.

V. HOW DOES YOUR ATMOSPHERIC WATER GENERATOR WORK?

It is important for you to understand that your Atmospheric Water Generator is a humidity and temperature driven machine. This means the machine totally depends on the level of humidity in the air and the right temperature to produce water. Ideally, the humidity level should be at least 50% or above to achieve the machine's optimum performance. In places with lower humidity level, the machine will still produce water but not as quickly, nor as much as in places with high level of humidity. In the house environment, higher level of humidity tends to be around the kitchen area, near an open window or in spacious rooms. This unit also performs well in an air-conditioned room, but it is recommended to open the window at night to have enough ventilation.

Because your Atmospheric Water Generator works by converting the humidity in the air to water, this unit also acts as an effective dehumidifier. In areas with high humidity, it not only acts as a good water generator, but also a perfect dehumidifier to keep you healthy and ensure your home appliances a long service time.

To ensure high quality of drinking water, The Atmospheric Water Generator is utilizing multiple filtration technologies.

When the air is dry or during cold season, water generation will be slow. At this moment, connection to city water will make the machine serve as water purifier by utilization of the filtration and sterilization system.

VI. FEATURES OF YOUR ATMOSPHERIC WATER GENERATOR

a. **Microcomputer**

The unit is fitted with a microcomputer, which ensures correct working of internal parts, to regulate hot or cool water temperature settings or supervise and control the functionality of individual parts inside the unit.

b. **Electronic Sensors**

Various electronic sensors are attached to parts such as UV light, heating mechanism and storage tanks. These sensors ensure that all parts are working properly and warn you should a breakdown or performance irregularities occur in the machine.

c. **Energy Saving Features**

To conserve electricity, electronic sensors have been placed in the storage tank to automatically stop the machine from generating more water when the tank is full and hot/cold water reaches to the maximum tank capacity.

d. **Child-proof Hot Water Lock out**

The function of hot water lockout is to prevent children from burning themselves upon touching the water tap.

e. **Venturi Fan**

Newly designed Venturi-type fan increases production efficiency and greatly reduce the noise during operation.

e. **Water Leakage Detector**

In case of any unexpected situation of water leakage, the machine will stop working automatically and warning sound and flashing VFD will be heard and seen.

f. **Condensing coils**

The condenser is designed especially and with food class coating to prevent any metal pollution and improve water production efficiency.

h. **Electrostatic Air Filter**

The first filter that air passes through before getting condensed and converted to water; our electrostatic air filter effectively prevents micro particles and dust from entering the machine, as well as slime and fungus growth.

i. **Ultraviolet Filter treatment**

The proprietary ultraviolet lamp treats the water for sterilization to ensure that all bacteria and microorganism are eliminated. Sterilization process is controlled by microcomputer automatically.

j. **Multi-Stage Filtration System**

Our dedication to providing high-quality, great tasting water to our customers is accomplished by our unique multi-stage filtration system.

- 1) LF2 Carbon Filter or Nanometer Molecular Sieve
Removes ammonia, chlorine residuals, organic compounds, soil particles, dirt, etc.
- 2) Sediment filter
Removes micro particles to protect the water pump.
- 3) Pre-Carbon Filter I
Removes organic compounds, chlorine, heavy metals, etc.
- 4) Pre-Carbon Filter II
Removes organic compounds, chlorine, heavy metals, etc.
- 5) Reverse Osmosis Membrane
Removes dangerous bacteria, viruses, minerals salt, heavy metals, organic compounds, etc.
- 6) Post-Carbon Filter
Removes volatile organic compounds and improves water taste and smell.
- 7) Top Tank UV Sterilization
Minimizes bacteria levels in top tank to the least amount.
- 8) Water Output UV Sterilization
Ensures clean and safe water is dispensed from cool water faucet.

k. Water Recirculation

Our patented exclusive technology ensures that stored water remains fresh and clean and prevents from second pollution.

l. Overheat Protector

Overheat protector offers further protection for your machine. In case of overheating in hot pot during heating process, this protector will automatically shut off heating device.

m. Novel and Noble Body

The Planets Water Atmospheric Water Generator has a smaller and sleeker design compared to other AWGs in the market. The unit is more compact and versatile. Advanced VFD displayer makes the operation, air humidity and water quality conditions easier to understand.

VII. OPERATING YOUR ATMOSPHERIC WATER GENERATOR

By following these simple instructions and simple maintenance procedures, your Water Generator should give you years of trouble-free operation while producing the maximum amount of pure, high-quality, drinking water that is not only healthy, but also beneficial to your health.

Please read this operation manual carefully before you start the machine. By reading and following the simple manual, you will familiarize yourself with your new water machine and all its functions, ensuring yourself of a machine constantly operating at its' optimum level.

D INDICATION

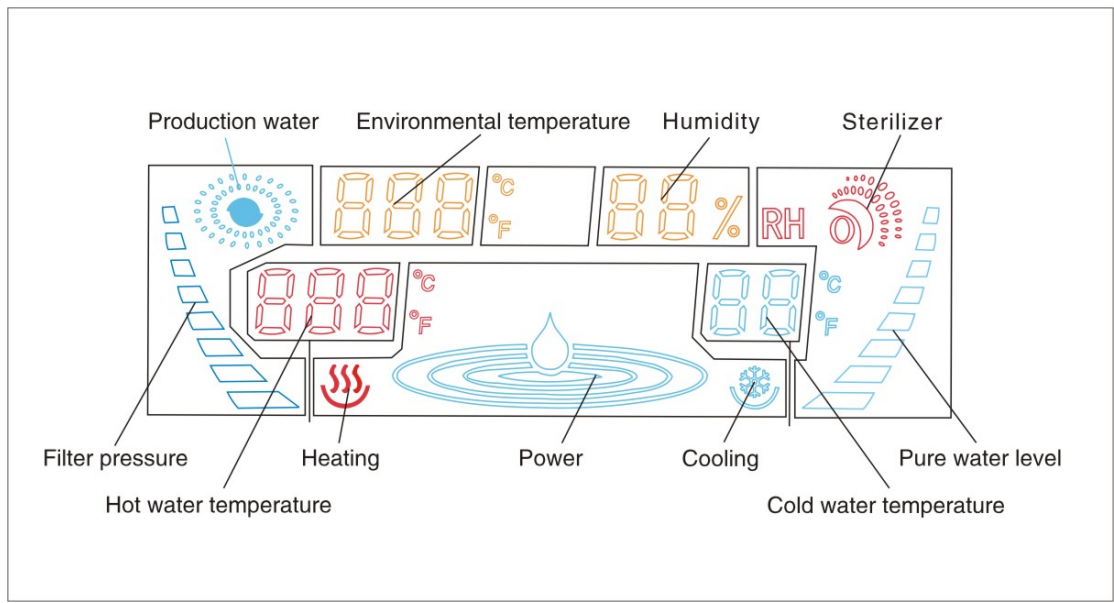
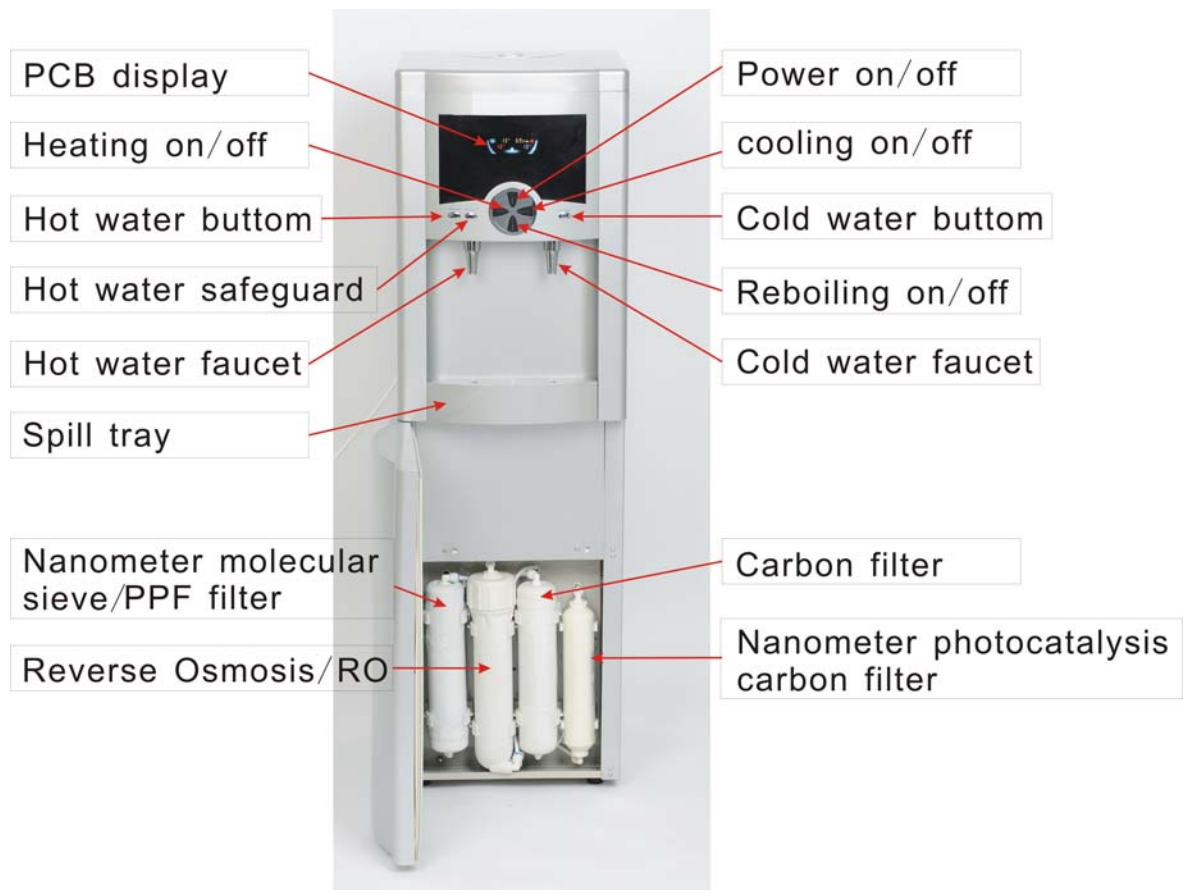

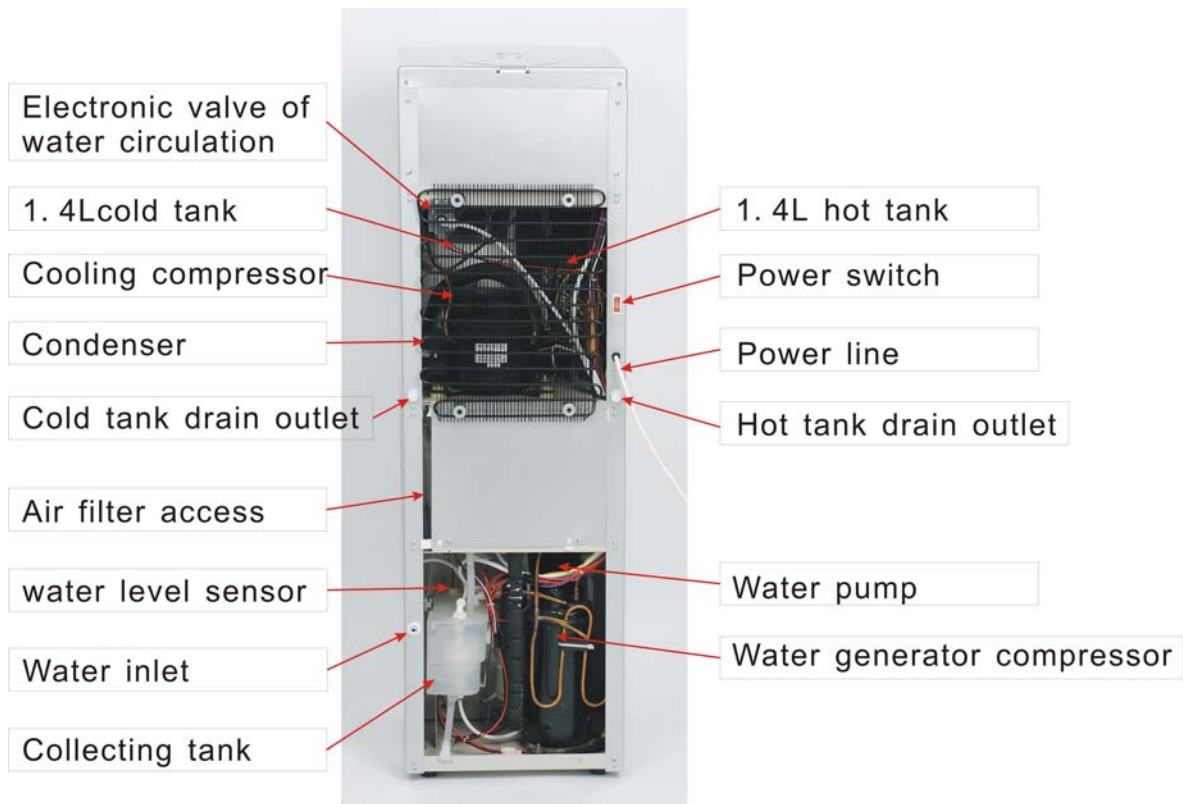





b. SETTING UP

1. Please confirm parts in the package are of the complete set. The unit should be placed on solid and level ground, and be located in place with good air circulation. The unit should be placed no less than 50 cm from the wall. Please lock the brakes by pushing down the levers on the wheels to get the machine in fixed position.
2. Do NOT connect the machine to power within the first half hour, letting the machine in a standing position to make sure the refrigerant agent to return to the compressor. Upon arrival, instant plugging to power may damage the compressor.
3. Make sure to use an electrical socket capable of handling not less than 10A.
4. For the first time operation, it is recommended to fill city water into bottom tank till top tank water level on screen indicating 3 levels. Then drain out one liter of water each by pressing Cool and Hot buttons. Drain off all the remaining water from the back HOT Water Drain outlet.

c. OPERATIONAL STAGE

1. When the unit starts to operate, you should be able to hear a “beep” sound,
The light on the VFD should also be lit. The compressor will run within 2 minutes, and you will see the corresponding light on the VFD is lit. If the unit is required to be shut off, keep POWER button pressed for 5 seconds. Press POWER again to switch it on.
2. Don't be alarmed when you don't obtain hot or cold water during the first few days of operation. Only when the water level in the tanks reaches to the right level then the heating/cooling mechanism will be triggered. (Generally, the first heating/cooling will start in ten to twenty hours during the first operation, depending on local temperature and humidity conditions.)
3. When there is enough water in your machine, you can press “HOT” key on the panel to switch on or off heating process. The red “” indicator will be lit on when heating is switched on. It will turn off when the machine is not in heating process. The heating mechanism will be triggered on and the red “” indicator will blink when water level reaches preset condition. It will turn off automatically when water is hot enough. During heating stage, press HOT button to switch off heating process.
4. When there is enough water in your machine, press “COOL” key on the panel to switch on or off cooling process. The green “” indicator light will be lit on when cooling is switched on. It will turn off when the machine is not on cooling process. The cooling mechanism will be triggered on and the green “” indicator will blink when water level reaches preset condition. It will turn off automatically when water is cool enough. During cooling stage, press COOL button to switch off cooling process.

5. Press C/F button to switch the temperature display between Celsius and Fahrenheit.
6. Generally, both heating and cooling can be turned on together. When the machine is in heating and cooling process, Hot and cold water temperature will remain in the preset range automatically.

Hold the C/F button to have the hot water temperature-display indicating the current setting. Then press HOT or COOL button to adjust the setting.

Press HOT to increase the setting value; press COOL to lower the value.

Hot water adjustment range is between 75°C~93°C.

To adjust cool water temperature setting, hold C/F again to have the Cool water temperature display indicating the current setting. Then press HOT or COOL button to adjust the setting.

Press HOT to higher the setting value, press COOL to lower the value.

Cool water adjustment range is between 4°C~10°C.

7. Time for the filtration system replacement.



REPLACE on display will blink to remind user to clean or change filters.

(Please refer to Filter Replacement for details)

After the cleaning or replacement is done, keep pressing RESET till the REPLACE indication stops blinking. Press RESET again to turn off REPLACE indication and to reset the replacement warning time.

8. The system will enter defrosting status and DEFROST indication on screen will blink when the environmental temperature is too low.

If it is required to check the current defrosting temperature, keep pressing COOL to show defrost temperature at the position of humidity level on screen.

9. Press  button to dispense cool water. To dispense hot water, keep pressing LOCK button till the HOT indication blinks and it gives beeping sound, then press  button to dispense hot water.
10. Don't be alarmed when your machine turns off automatically. To conserve energy, your machine has been fitted with an electronic sensor, which automatically switches the machine off when the storage tank is full.

11. When the air is dry or during cold season, water generation will be slow. At this moment, external connection to city water will make the machine serve as water purifier by utilization of the filtration and sterilization system. (Some parts are optional. Please contact our local distributor for additional or spare parts). When power is switched on, the machine will automatically turn into operation.

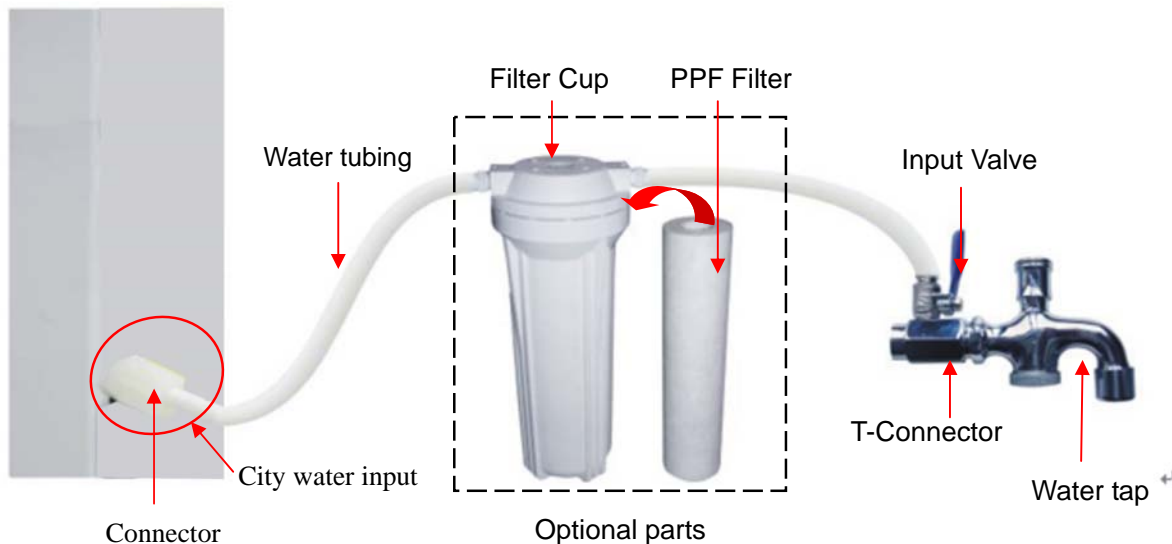

For the first operation, when the top tank is full of generated water, please follow the steps in CLEANING, STERILIZATION & REPLACEMENT below:

12. CLEANING AND REPLACEMENT OF FILTERS

Recommended Timing for Filter Replacement (It might be verified according to different water consumption. The timing below is based on 10 liters water consumption per day):

- | | |
|---|------------------------------------|
| 1) LF2 Carbon Filter or Nanometer Molecular Sieve | 3-6 months |
| 2) Pre-Carbon Filter I | 6 months |
| 3) Pre-Carbon Filter II | 6 months |
| 4) Reverse Osmosis Membrane | 24 months |
| 5) Post-Carbon Filter | 6 months |
| 6) UV bulb | 12 months or upon UV fault warning |

Note: 1. The above recommended service timing is for reference only.
2. After a long period of service, we recommend that you replace the filters to ensure that your unit will always produce the cleanest and purest drinking water effectively.

1. Cleaning

1.1 Cleaning the Air Filter

Please clean air filter regularly according to the air pollution situation in order to ensure optimum air supply. Take off air filter from the side as shown in picture 1.1-1, 1.1-2, 1.1-3. Rinse in clean water to remove dirt and then put it back.

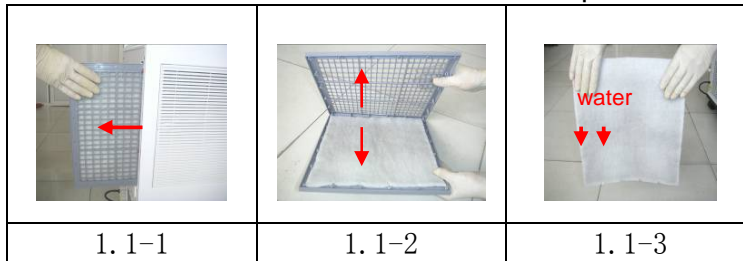

2. Replacement

2.1 Replacing the filters

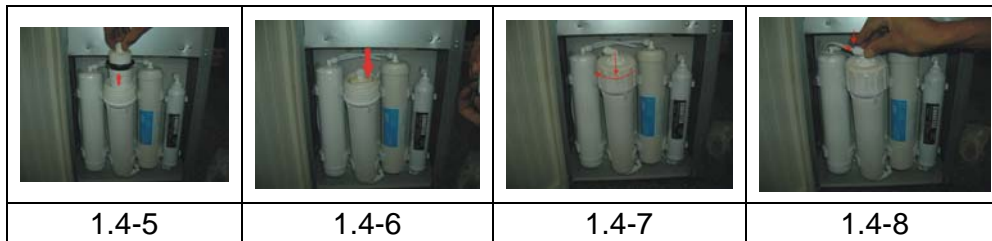
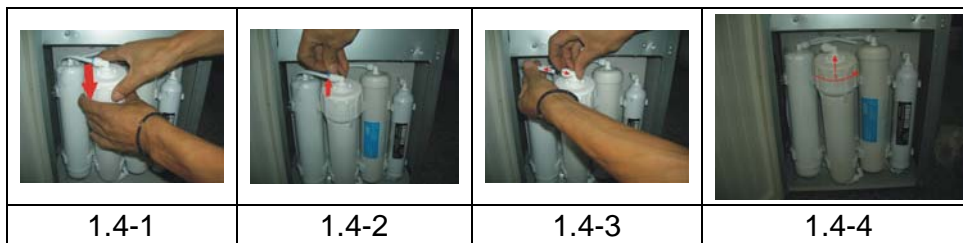

2. Sterilization

A brand new machine should be sterilized after one week of service.

2.1 Preparing a sterilization solution: Prepare 15 liters of sterilization solution (special solution for water dispenser). We recommend using a hydrogen peroxide solution.

2.2 Hold pressing POWER to shut down the unit, open top cover open top tank cover fill in the solution in to the top tank, replace back top tank cover and make sure it's tightly closed. Replace back top cover.

2.3 Turn on the unit. Press “❄️” and keep pressing HOT to unlock and press “🔥” to release 1 L of solution from each faucet. Shut down the unit. Drain off about 0.5L of the remaining solution from hot water drain outlet at the back. Keep the remaining solution soaking in the top tank for more than 2 hours. (As per instructions of the solution you have)

2.4 Run the unit. Press “❄️”、keep pressing HOT to unlock and press “🔥” to release 2 L of solution each from faucet. Shut down the unit. Drain all remaining solution from hot water drain outlet at the back.

2.5 Fill city water into bottom tank. Turn on the unit and have it running automatically till top tank is full of water.

2.6 Keep pressing HOT to unlock and press “🔥” to release 2 L of water each from faucet. Shut down the unit. Drain off all remaining water from hot water drain outlet at the back.

2.7 Repeat the above steps in 2.5 and 2.6 in order to clean off the remaining solution in the top tank. We suggest applying this procedure twice.

3. Replacement

3.1 Replacing the filters

- a. Keep pressing POWER to shut down the unit. Remove front panel by both hands from the bottom.
- b. Replace carbon filter by pulling out tubing at both ends.
- c. Replace RO membrane by pulling out tubing, removing cartridge cover, removing the membrane and replacing with new one.
- d. Close the front panel.

Note: 1. Please replace each filter one by one and in order.

2 .When replacements is done, please clean the filtration system as per
FILTRATION CLEANING.

3.2 Replacing the top UV

- a. Switch off the unit and unplug power cable from the main electricity.
- b. Open top cover.
- c. Remove screws on top end.
- e. Disconnect UV connection pin. Pull out UV bulb.
- f. Replace with the new bulb and close back the top cover.

3.3. Replacing the cool-water UV

- a. Switch off the unit and unplug power cable from the main electricity.
- b. Open top cover.
- c. Remove foam cup of UV.
- d. Remove black insulation cover.
- e. Disconnect UV connection pin. Pull out UV bulb.
- f. Replace with the new bulb and put back all parts.

4. Attention:

- 4.1. It is recommended to dispense not less than 3 liters of water every day.
- 4.2. If hot water is not dispensed for a long period, it is recommended to turn on heating process for more than 30 minutes once a week. Keep pressing HOT button to unlock and press  to release 500 ml of hot water from faucet.
- 4.3. If the machine was not in use for 2 to 5 days, please drain out 500ml of cool water before drinking usage. If the machine is to be inactive for more than 5 days, it is recommended to drain off water in all tanks and switch off the machine in advance. For its reactivation, please run the system to produce about 5 liters of water, and drain off from the back drain outlets.
- 4.4. If the machine was not in use for more than 7 days or it has been in continuous operation for more than 4 months, please follow the steps in CLEANING, STERILIZATION & REPLACEMENT to sterilize the system.
- 4.5. Switch off the power before draining out water from the back outlets.

VIII. TROUBLE SHOOTING

Problem: The UV WARNING light  blinks and with three short beeps.

Solution: Check the ultraviolet device next to the top tank to make sure the bulb is lit on and all wirings are correct. If the UV is not working, replace with new bulb by following steps in CLEANING, STERILIZATION & REPLACEMENT.

Problem: The whole UV WARNING logo  blinks and with three short beeps.

Solution: Check the ultraviolet device at cool water output to make sure the bulb is lit on and all wirings are correct. If the UV is not working, replace with new bulb by following steps in CLEANING, STERILIZATION & REPLACEMENT.

Problem: The machine does not work even after the power cord is plugged in.

Solution: Check for power voltage and ensure that it is in the correct range for operation. Make sure that the connection to the wall socket is tight and secure.

Problem: the indicator  “REPLACE” on VFD display is blinking with beeps.

Solution: After a long period of operation, the filter might be over dirty and will be replaced. Replace with a new filter by following steps in CLEANING, STERILIZATION & REPLACEMENT. Reset the filtration warning time by following the 7th step in section OPERATIONAL STAGE.

Problem: The system detected water leakage on base. The red logo  on screen blinks and the system cannot produce water.

Solutions:

- Keep pressing POWER button immediately and unplug power cord.
- Check all tubing of filtration system and make sure they are all tight and secure.
- Check the tubing of bottom tank and make sure it is tight and secure.
- Check the draining tubing at the back and make sure it is tight and secure.
- Check the water collector is on correct position.

Problem: Remaining water can not be drained out from the back outlets when cleaning top tank and hot tank.

Solutions: Check water stopper inside water drainage to see if the outlet is removed.

Problem: There is burning smell from the machine and meanwhile hot temperature indication has exceeded the preset.

Solutions:

- Keep pressing POWER button immediately and unplug power cord.
- Stop draining immediately if you are on draining operation from the back. Wait and continue draining until hot temperature is normal.

Problem: Water output from faucet is too small.

Solutions:

- Clean the filter net inside water faucet or replace with new one.
- Replace with new check valve inside water faucet.

Problem: No hot or cool water output but only room temperature water only.

Solutions:

- The heating function will be activated only when top tank water level on the screen is above two levels.
- The cooling function will be activated only when top tank water level on the screen is above three levels

Problem: The machine generates water at a slow rate even after prolonged period of operation.

Solutions:

- Make sure the temperature level is in optimal range.
- Check the humidity level in the room. Low humidity level results in less water production.
- Make sure that the hot/cold water spouts are not blocked.
- Make sure that the ingoing and outgoing air ventilation is not blocked.
- Check that the distance between the machine and the wall is not too close.
- Make sure that the power voltage is not too low or too high.
- Make sure that the internal booster pump is working well.
- Make sure that the water lines are not blocked and water flow is smooth.
- Make sure that the unit is placed in a good ventilation condition, and the air filter net is cleaned regularly to ensure the free air flow.

Problem: The humidity indication on screen is different from the real room humidity level.

- It is normal if the difference is in range of 5% more or less.
- Make sure the machine and the individual Humistat are placed in same place. Make sure that the Humistat sensor is not blocked, covered or too close to the wall.

Problem: The machine has excessive vibration or noise.

- Make sure there is no object placed on top of the machine.
- Make sure that there is no water cup placed on water tray.
- Open the front bottom panel and check if the copper tube at the side is touching the side panel. If it is then please correct the position of copper tube gently.

Once all the above procedures have been performed and your machine still does not work or does not work correctly, please do not try to perform other repair procedures yourself. Always call a qualified service technician to look at the machine and perform the repair procedures. We are not responsible for any damages incurred during self-repairing which will void all warranty.

IX. TECHNICAL SPECIFICATIONS

a. Dimensions: 40 X 54 X 111 cm

b. Net Weight: 48 kg

c. Power Supply	220-240V 50Hz 220-240V 60Hz	100-120V 50Hz 100-120V 60Hz
Power input	1000-1150W	900-1150W
Heating Wattage	500-600W	500-600W
Operation Power	450-500W	450-500W

d. Technical Data

Working Temperature	15°C ~ 40°C
Working Humidity	35% ~ 95%
Water Storage Capacity	18 Liters
Hot Water Temperature	75°C ~ 93°C
Cold Water Temperature	4°C ~ 10°C

Atmospheric Water Production Capacity :

